



**State of Alaska
Department of Fish and Game
Sportfish Division**

**Nomination Form
Anadromous Waters Catalog**

Region Southcentral USGS Quad(s) TALKEETNA A-1, B-1, B-2

Anadromous Waters Catalog Number of Water Body 247-41-10200-2081-3100-4167 (-5043) (-5044)

Name of Water Body Gate Creek USGS Name Local Name

Addition Deletion Correction Backup Information

For Office Use

| | | |
|---|--|-----------------------------|
| Nomination # <u>25-635</u> | <u>[Signature]</u> Fisheries Scientist | <u>Sept 05 2025</u> Date |
| Revision Year: <u>2026</u> | <u>[Signature]</u> Habitat Operations Manager | <u>9/5/25</u> Date |
| Revision to: <input checked="" type="checkbox"/> Atlas <input checked="" type="checkbox"/> Catalog | <u>[Signature]</u> AWC Project Biologist | <u>21 Aug 2025</u> Date |
| Revision Code: <u>B-1, F-1</u> | <u>[Signature]</u> GIS Analyst | <u>9/23/2025</u> Date |

OBSERVATION INFORMATION

| Species | Date(s) Observed | Spawning | Rearing | Present | Anadromous |
|------------------------|------------------------|----------|---------|---------|------------|
| coho salmon (x10) | 06/14/2019 | | ✓ | | ✓ |
| coho salmon (x13) | 06/13/2019 | | ✓ | | ✓ |
| chinook salmon (x3) | 06/16/2022 | | ✓ | | ✓ |
| chinook salmon (x1) | 08/10/2022 | | ✓ | | ✓ |
| coho salmon (x65) (x7) | 06/17/2019, 07/15/2020 | | ✓ | | ✓ |

~ADD new species CHINOOK salmon REARING & PRESENT to existing AWC Stream #247-41-10200-2081-3100-4167 "Gate Creek".

**Observations in this nomination also provide back-up supporting information for Coho salmon rearing in existing AWC Stream #247-41-10200-2081-3100-4167 "Gate Creek" and tributaries #247-41-10200-2081-3100-4167-5044 and #247-41-10200-2081-3100-4167-5043.*

Comments: **see Noms #25-631 through #25-641*
 Please note additional attachments as data in online nomination may not be complete. Site ID: PGC1, PGC2, PGCT2, PGCT1
 Project Description: To supplement limited knowledge of juvenile salmon thermal requirements and habitat availability, USFWS performed comprehensive monitoring and modeling efforts—including habitat, temperature, and streamflow data collection—to define thermal niches for Chinook and Coho salmon.
 Methods: Ten minnow traps were baited with salmon roe and deployed along each designated stream reach along 100 meter transects, and data including stream flow, temperature, and habitat observations were collected. After one hour, traps were pulled to ID, measure, weigh, and document juvenile salmon and other miscellaneous species.

Name of Observer (please print): Emma Craig +
 Signature: 10.231.39.10 (Web Nomination) Date: 06/30/2025
 Agency: _____
 Address: 4700 BLM Rd
Anchorage, AK 99507

This certifies that in my best professional judgment and belief the above information is evidence that this waterbody should be included in or deleted from the Anadromous Waters Catalog.

Signature of Area Biologist: _____ Date: _____ Revision 3/16
 Name of Area Biologist (please print): _____

| Species | Site | Trap # | # Fish | Lat | Long | AWC Code | River Name | Region | Date Observed | Group # |
|---------|---------|--------|--------|-----------|-------------|---------------------------------------|--------------------------------|--------|---------------|---------|
| CO | PTCI | 3 | 1 | 62.35422 | -150.664343 | 247-41-10200-2081-3181 | Twenty Mile Creek | SCN | 6/18/2024 | 1 |
| CO | PKC1 | 1 | 38 | 62.348134 | -150.622206 | 247-41-10200-2081 | Kroto Creek | SCN | 6/19/2019 | 2 |
| CO | KrotoIU | 2 | 3 | 62.31729 | -150.644178 | 247-41-10200-2081 | Kroto Creek | SCN | 8/6/2019 | 2 |
| CO | PKCT2 | 1 | 7 | 62.346693 | -150.649437 | 247-41-10200-2081-3197 | Kroto Creek Tributary | SCN | 7/9/2020 | 2 |
| K | KrotoIT | 9 | 1 | 62.31639 | -150.64259 | 247-41-10200-2081 | Kroto Creek | SCN | 8/6/2019 | 2 |
| K | PKC1 | 2 | 2 | 62.348134 | -150.622206 | 247-41-10200-2081 | Kroto Creek | SCN | 6/30/2023 | 2 |
| CO | PKCT1 | 9 | 1 | 62.340046 | -150.60626 | 247-41-10200-2081-3196 | Kroto Creek Tributary | SCN | 6/18/2019 | 3 |
| CO | PSM1 | 1 | 3 | 62.337125 | -150.574021 | 247-41-10200-2081-3194 | Seventeen Mile Creek | SCN | 6/15/2022 | 4 |
| CO | PSM2 | 1 | 11 | 62.333784 | -150.56621 | 247-41-10200-2081-3194 | Seventeen Mile Creek | SCN | 6/21/2024 | 4 |
| CO | PSMT1 | 1 | 4 | 62.336678 | -150.564283 | 247-41-10200-2081-3194-4016 | Seventeen Mile Creek Tributary | SCN | 6/22/2024 | 4 |
| CO | PGC1 | 1 | 10 | 62.326171 | -150.522439 | 247-41-10200-2081-3100-4167 | Gate Creek | SCN | 6/14/2019 | 5 |
| CO | PGC2 | 1 | 13 | 62.323712 | -150.519428 | 247-41-10200-2081-3100-4167 | Gate Creek | SCN | 6/13/2019 | 5 |
| CO | PGCT2 | 1 | 65 | 62.324771 | -150.537098 | 247-41-10200-2081-3100-4167-5043 | Gate Creek Tributary | SCN | 6/17/2019 | 5 |
| CO | PGCT1 | 1 | 7 | 62.326224 | -150.518549 | 247-41-10200-2081-3100-4167-5044 | Gate Creek Tributary | SCN | 7/15/2020 | 5 |
| K | PGC1 | 3 | 3 | 62.326032 | -150.521674 | 247-41-10200-2081-3100-4167 | Gate Creek | SCN | 6/16/2022 | 5 |
| K | PGC2 | 2 | 1 | 62.323712 | -150.519428 | 247-41-10200-2081-3100-4167 | Gate Creek | SCN | 8/10/2022 | 5 |
| CO | PMCT1 | 1 | 2 | 62.319746 | -150.463058 | 247-41-10200-2081-3100-4187 | Moose Creek Tributary | SCN | 6/13/2019 | 6 |
| CO | PWMC1 | 1 | 11 | 62.320233 | -150.442443 | 247-41-10200-2081-3100-4189 | West Fork Moose Creek | SCN | 6/11/2019 | 6 |
| CO | MooseID | 1 | 12 | 62.31551 | -150.449 | 247-41-10200-2081-3100 | Moose Creek | SCN | 6/17/2019 | 6 |
| CO | PMCI | 1 | 37 | 62.317608 | -150.436347 | 247-41-10200-2081-3100 | Moose Creek | SCN | 7/8/2020 | 6 |
| CO | PMC2 | 1 | 3 | 62.3157 | -150.446772 | 247-41-10200-2081-3100 | Moose Creek | SCN | 6/13/2022 | 6 |
| K | MooseID | 4 | 3 | 62.31551 | -150.449 | 247-41-10200-2081-3100 | Moose Creek | SCN | 6/17/2019 | 6 |
| K | PMCI | 1 | 4 | 62.317608 | -150.436347 | 247-41-10200-2081-3100 | Moose Creek | SCN | 6/16/2022 | 6 |
| K | PMC2 | 1 | 5 | 62.3157 | -150.446772 | 247-41-10200-2081-3100 | Moose Creek | SCN | 6/13/2022 | 6 |
| K | PWMC1 | 1 | 5 | 62.320233 | -150.442443 | 247-41-10200-2081-3100-4189 | West Fork Moose Creek | SCN | 6/13/2022 | 6 |
| CO | PNCT1 | 1 | 2 | 62.309835 | -150.368252 | 247-41-10200-2081-3100-4136-5027 | Ninemile Creek Tributary | SCN | 6/10/2019 | 7 |
| CO | PNCT2 | 1 | 2 | 62.310813 | -150.373878 | 247-41-10200-2081-3100-4136-5027-4009 | Ninemile Creek Tributary | SCN | 6/29/2023 | 7 |
| K | PNCT1 | 3 | 2 | 62.309352 | -150.368452 | 247-41-10200-2081-3100-4136-5027 | Ninemile Creek Tributary | SCN | 6/30/2023 | 7 |
| CO | PNCI | 2 | 5 | 62.312401 | -150.34735 | 247-41-10200-2081-3100-4136 | Ninemile Creek | SCN | 6/13/2022 | 8 |
| CO | OMCT1 | 1 | 2 | 62.237076 | -150.440582 | 247-41-10200-2081-3100-4166 | Moose Creek Tributary | SCN | 6/30/2023 | 9 |
| K | OMCT1 | 1 | 2 | 62.237076 | -150.440582 | 247-41-10200-2081-3100-4166 | Moose Creek Tributary | SCN | 6/19/2019 | 9 |
| CO | OMCT2 | 1 | 5 | 62.213297 | -150.475312 | 247-41-10200-2081-3100-4155-5008 | Moose Creek Tributary | SCN | 7/16/2020 | 10 |
| CO | OMCT4 | 1 | 3 | 62.204341 | -150.471837 | 247-41-10200-2081-3100-4155 | Moose Creek Tributary | SCN | 7/1/2023 | 10 |
| CO | OML1 | 1 | 2 | 62.203264 | -150.473496 | 247-41-10200-2081-3100-4155 | Whistling Lake Outlet | SCN | 7/1/2023 | 10 |
| CO | OMCT3 | 1 | 4 | 62.204451 | -150.476289 | 247-41-10200-2081-3100-4155-5014 | Moose Creek Tributary | SCN | 6/30/2023 | 10 |
| K | OMCT3 | 6 | 3 | 62.204443 | -150.475402 | 247-41-10200-2081-3100-4155-5014 | Moose Creek Tributary | SCN | 6/20/2019 | 10 |
| K | OMCT4 | 5 | 1 | 62.204444 | -150.471133 | 247-41-10200-2081-3100-4155 | Moose Creek Tributary | SCN | 7/1/2023 | 10 |
| CO | OCC2 | 1 | 5 | 62.072697 | -150.584883 | 247-41-10200-2081-3065 | Chijuk Creek | SCN | 7/13/2021 | 11 |
| CO | OCC1 | 1 | 5 | 62.080703 | -150.58422 | 247-41-10200-2081-3065 | Chijuk Creek | SCN | 7/13/2021 | 11 |
| CO | OCCT1 | 1 | 2 | 62.074882 | -150.5877 | 247-41-10200-2081-3065-4027 | Chijuk Creek Tributary | SCN | 8/2/2022 | 11 |
| K | OCC2 | 5 | 1 | 62.072294 | -150.58478 | 247-41-10200-2081-3065 | Chijuk Creek | SCN | 6/20/2019 | 11 |
| K | OCCT1 | 3 | 1 | 62.074667 | -150.587112 | 247-41-10200-2081-3065-4027 | Chijuk Creek Tributary | SCN | 7/13/2021 | 11 |
| K | OCC1 | 5 | 1 | 62.08039 | -150.584577 | 247-41-10200-2081-3065 | Chijuk Creek | SCN | 6/29/2023 | 11 |

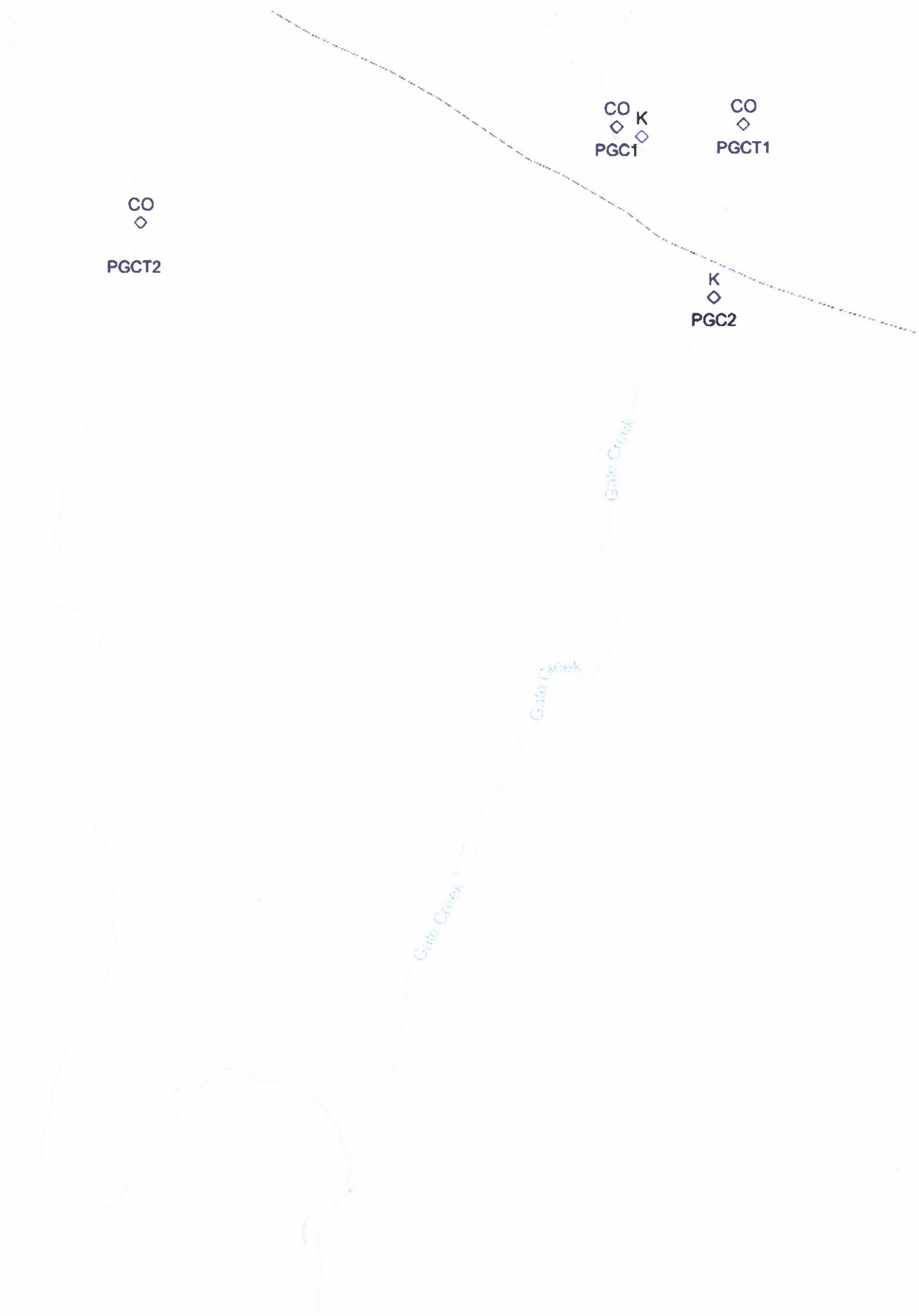

CO
◇
PGCT2

CO
◇
K
◇
PGC1

CO
◇
PGCT1

K
◇
PGC2

Gate Creek

Gate Creek

Gate Creek

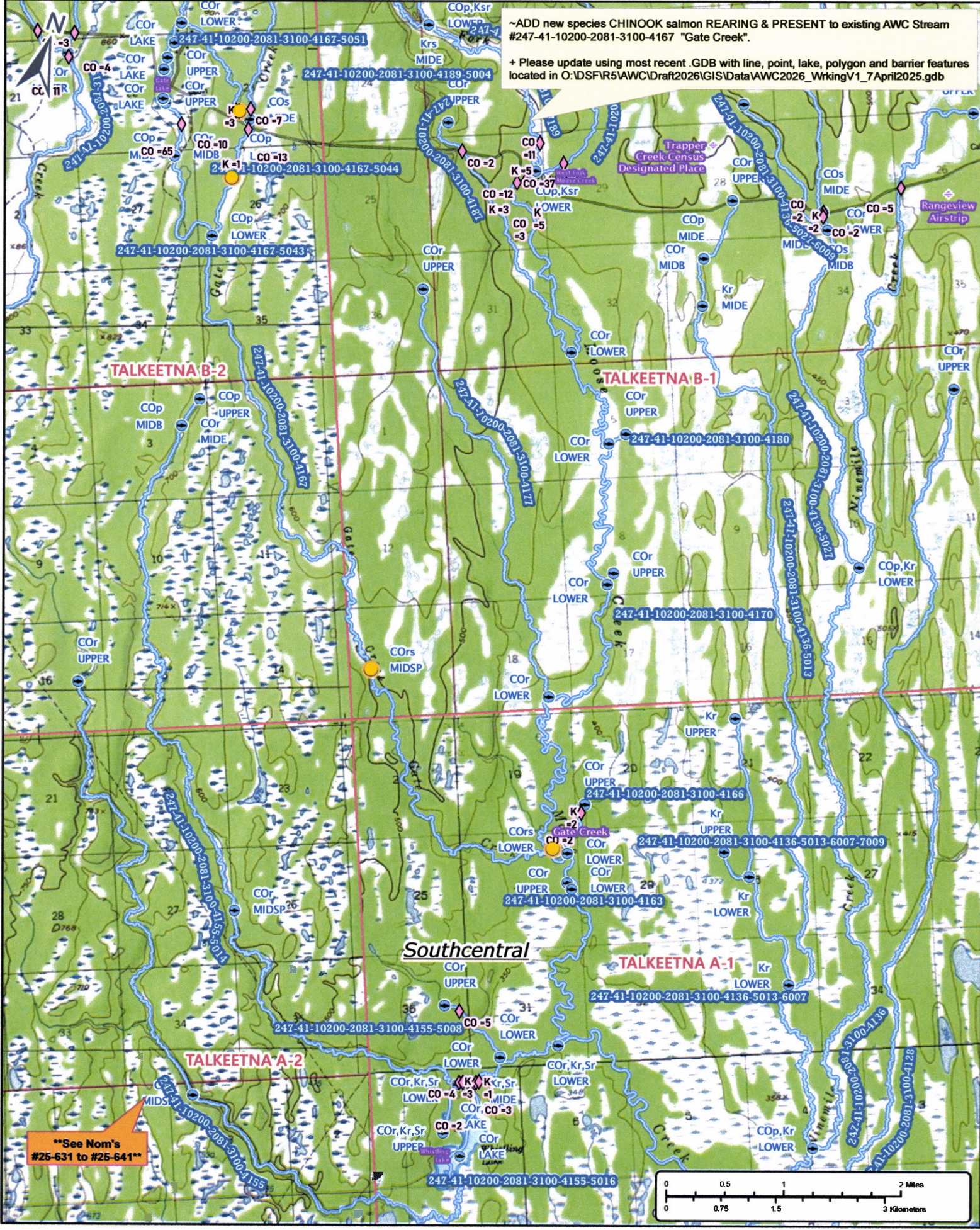

-ADD new species CHINOOK salmon REARING & PRESENT to existing AWC Stream #247-41-10200-2081-3100-4167 "Gate Creek".

+ Please update using most recent .GDB with line, point, lake, polygon and barrier features located in O:\DSF\5\AWC\Draft2026\GIS\Data\AWC2026_WrkingV1_7April2025.gdb

TALKEETNA B-2

TALKEETNA B-1

Southcentral

TALKEETNA A-1

TALKEETNA A-2

****See Nom's #25-631 to #25-641****

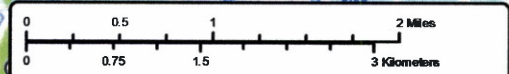

Nom #25-635

Map #1

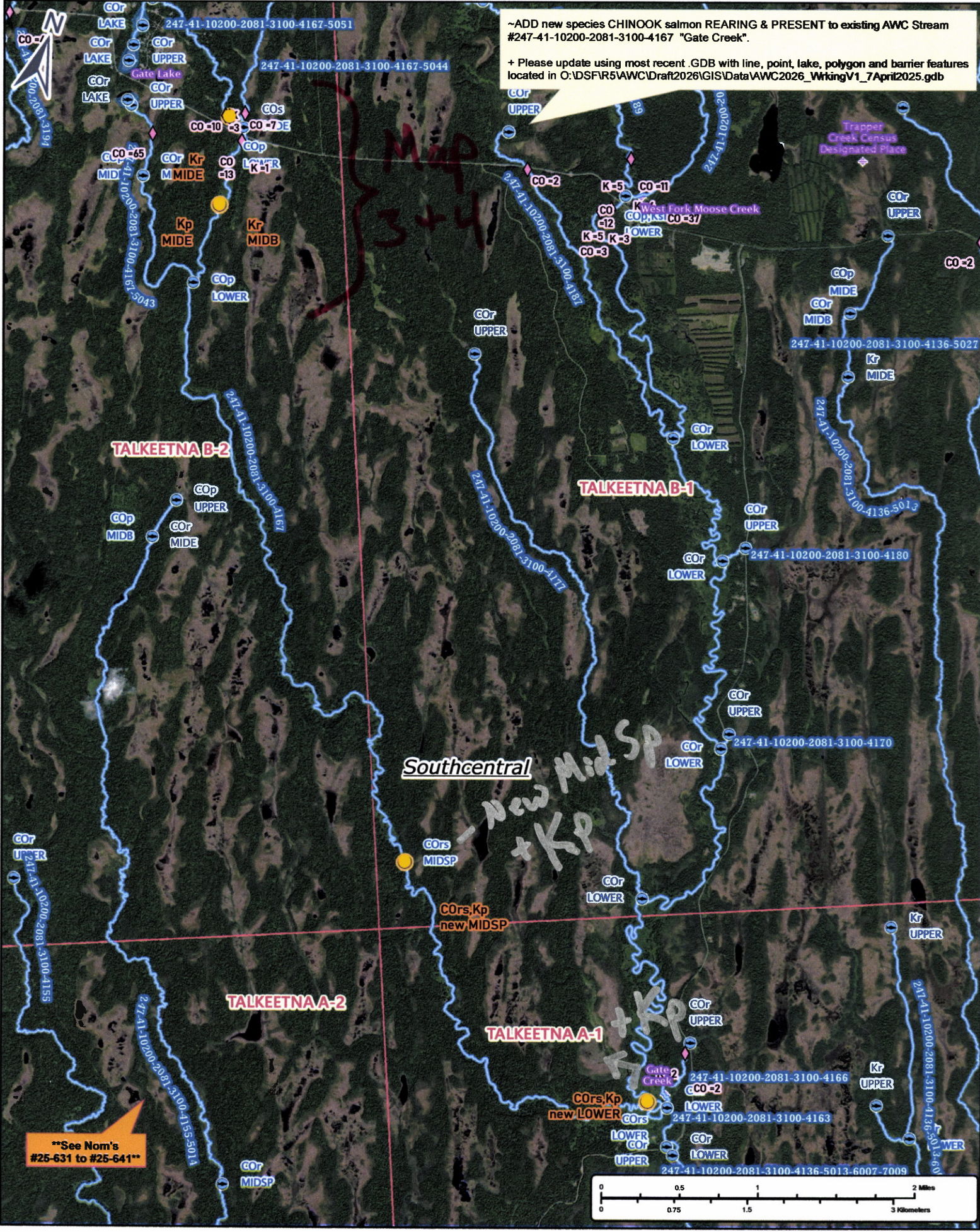

~ADD new species CHINOOK salmon REARING & PRESENT to existing AWC Stream #247-41-10200-2081-3100-4167 "Gate Creek".
 + Please update using most recent .GDB with line, point, lake, polygon and barrier features located in O:\DSF\5VAWC\Draft2026\GIS\Data\VAWC2026_V\WritingV1_7April2025.gdb

See Nom's #25-631 to #25-641

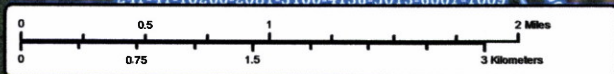

Nom # 25-635

Map # 2

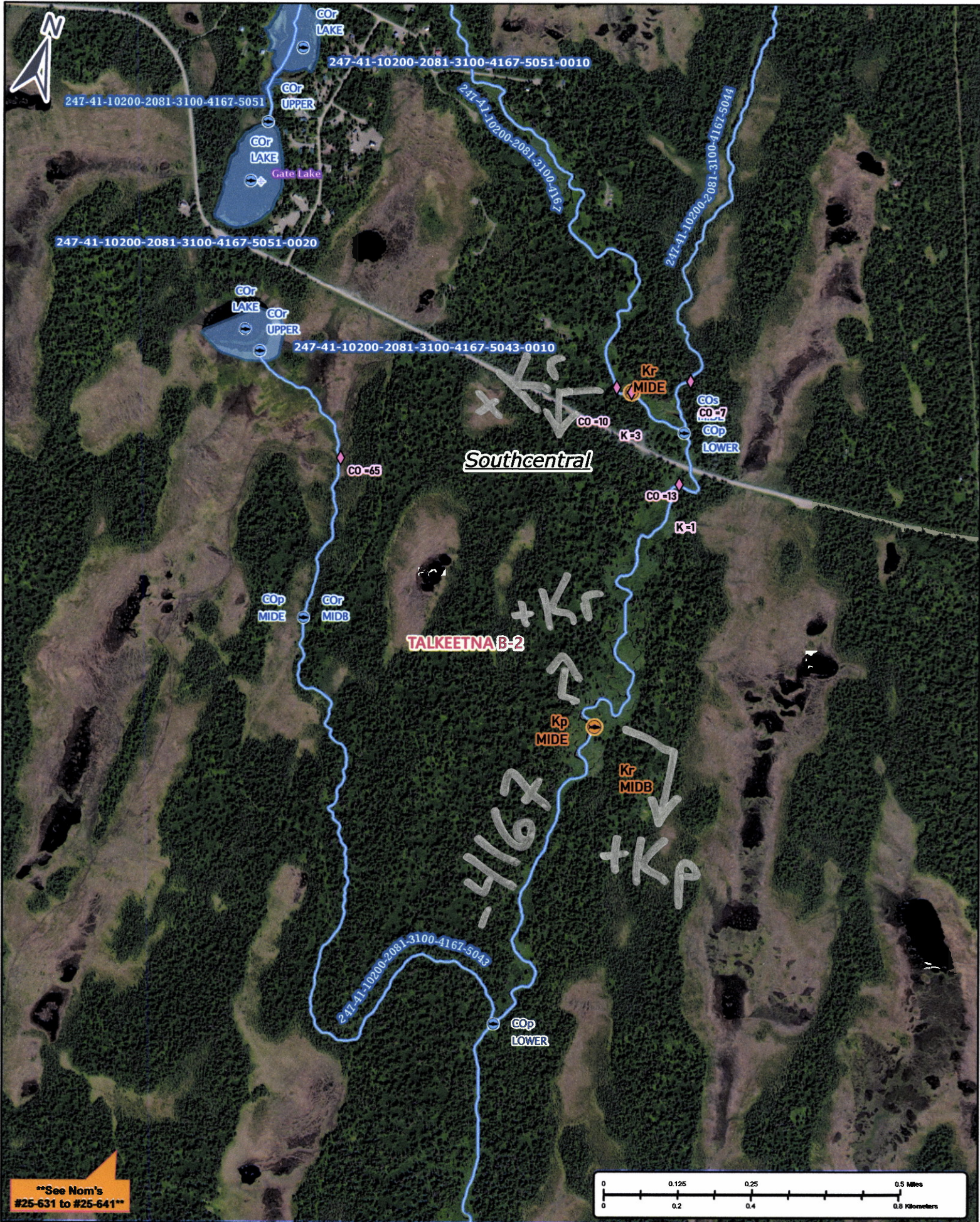

Nom # 25-635

Map # 3

~ADD new species CHINOOK salmon REARING & PRESENT to existing AWC Stream #247-41-10200-2081-3100-4167 "Gate Creek".

+ Please update using most recent .GDB with line, point, lake, polygon and barrier features located in O:\DSF\R5\AWC\Draft2026\GIS\Data\AWC2026_WorkingV1_7April2025.gdb



See Nom's #25-631 to #25-641

Nom #25-635

Map #4