



State of Alaska
Department of Fish and Game
Sportfish Division



Nomination Form
Anadromous Waters Catalog

Region Southeastern USGS Quad(s) BERING GLACIER A-4 SW

Anadromous Waters Catalog Number of Water Body 191-10-11470-2000

Name of Water Body *Mink Creek USGS Name Local Name
 Addition Deletion Correction Backup Information

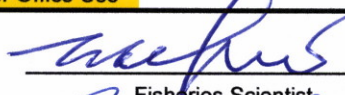
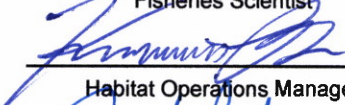
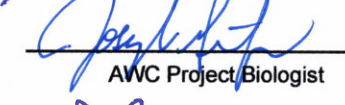
For Office Use

Nomination # <u>25-542</u>		<u>8/11/2025</u>
Revision Year: <u>2026</u>	Fisheries Scientist	Date
Revision to: <input checked="" type="checkbox"/> Atlas		<u>9/9/2025</u>
<input checked="" type="checkbox"/> Catalog	Habitat Operations Manager	Date
Revision Code: <u>A-2d</u>		<u>31 July 2025</u>
	AWC Project Biologist	Date
		<u>4/13/2025</u>
	GIS Analyst	Date

OBSERVATION INFORMATION

Species	Date(s) Observed	Spawning	Rearing	Present	Anadromous
coho salmon	06/14/2024		✓		✓

~ADD new AWC Stream #191-10-11470-2000 ""Mink Creek" with COHO salmon REARING.

Comments:
Coordinates (Lat,Long): Upper(60.075410,-142.462951) Lower(60.075724,-142.463745)

Name of Observer (please print): Nicholas Jensen
 Signature: 10.231.39.10 (Web Nomination) Date: 04/21/2025
 Agency: _____
 Address: 802 3rd St First Floor
Juneau, AK 99824

This certifies that in my best professional judgment and belief the above information is evidence that this waterbody should be included in or deleted from the Anadromous Waters Catalog.
 Signature of Area Biologist: _____ Date: _____ Revision 3/16
 Name of Area Biologist (please print): _____

Alaska Department of Fish and Game

Habitat Section
Southeast Region



191-10-11470 Tributary 1

ADDITION

Water body name: Mink Creek

Survey date: 6/14/2024

Quad: Bering Glacier A-4

Species & Lifestage:

Upper Reach Latitude: 60.075410 **Longitude:** -142.462951

Survey crew: NJ, GA, FC

Lower Reach Latitude: 60.075724 **Longitude:** -142.463745

Findings: We surveyed this uncataloged stream using a backpack electrofisher and GPS and captured juvenile coho salmon and stickleback. This channel is man made and comprised of ponded water near a dredging operation. Substrate is sand and fine organics; banks are a mix of exposed substrate and vegetation (Table 1; Figures 1, 2).

Recommendations: Add this uncataloged stream to the anadromous waters catalog for rearing coho salmon up to waypoint 254 (Figure 3).

Nomination: Pending

Table 1.—191-10-11470 tributary 1 survey data.

Waypoint	Latitude	Longitude	Notes	Stream Width ft	Stream Substrate	Habitat Features	Gradient %	Sample Effort	Sample Results
254	60.075357	-142.462876		12-15	Sand Fine Organic		0-1	MT	11 CO 12 SB



Figure 1.—Juvenile coho salmon caught at waypoint 254.



Figure 2.—Ponded water at waypoint 254.



Figure 3.–191-10-11470 tributary 1 addition map.

~ADD new AWC Stream #191-10-11470-2000 "Mink Creek" with COHO salmon REARING.

+ Please update using most recent .GDB with line, point, lake, polygon and barrier features located in O:\DSFR5AWC\Draft2026\GIS\Data\AWC2026_WrkingV1_7April2025.gdb



Now #25-542

Map #1



~ADD new AWC Stream #191-10-11470-2000 "Mink Creek" with COHO salmon REARING.
 + Please update using most recent .GDB with line, point, lake, polygon and barrier features located in O:\DSF\RS\AWC\Draft2026\GIS\Data\AWC2026_WorkingV1_7April2025.gdb

Nov #25-542

Map #2

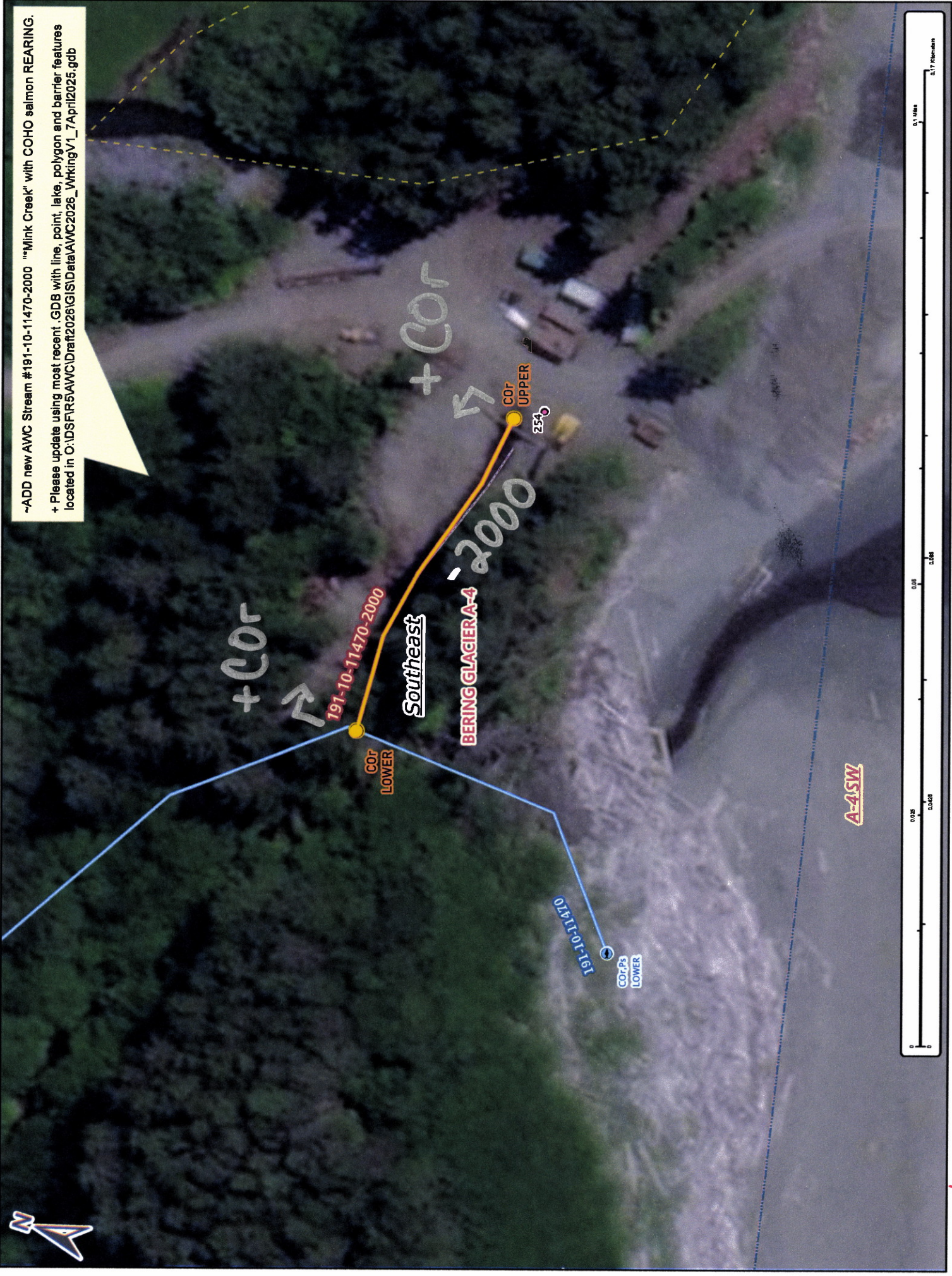

~ADD new AWC Stream #191-10-11470-2000 "Mink Creek" with COHO salmon REARING.
 + Please update using most recent .GDB with line, point, lake, polygon and barrier features located in O:\DSF\IR5\AWC\Draft2026\GIS\Data\AWC2026_WorkingV1_7April2025.gdb

Num #25-542

Map #3